

KEY	QTY.	BOTANICAL NAME	COMMON NAME	Size	CONDITION/SPACING
<b>ZONES 4-5 TREES</b>					
AR	21	Acer Rubrum	Red Maple	60mm	B4B
BP	6	Betula Papyrifera	White Birch	30mm	Potted
PT	11	Populus Tremuloides	Trembling Aspen	30mm	Potted
QM	1	Quercus Macrocarpa	Bur Oak	60mm	B4B
TA	10	Tilia Americana	Basswood	30mm	Potted
<b>CONIFERS</b>					
LL	18	Larix Laricina	Tamarack	2.0m Ht.	Potted
PG	14	Picea Glauca	White Spruce	2.0m Ht.	Potted
TC	60	Thuja Occidentalis	Eastern White Cedar	2.0m Ht.	Potted
<b>SHRUBS</b>					
A1	175	Alnus Incana	Speckled Alder	Ø5 - 12m Ht.	Potted, 1m SPACING
Ca	160	Cornus Alternifolia	Alternate Leaved Dogwood	Ø5 - 12m Ht.	Potted, 1m SPACING
Hv	130	Hamamelis Virginiana	Witch Hazel	Ø5 - 12m Ht.	Potted, 1m SPACING
Rt	100	Rhus Typhina	Sumac	Ø5 - 12m Ht.	Potted, 1m SPACING
Sb	205	Salix Baccifera	Bebb's Willow	Ø5 - 12m Ht.	Potted, 1m SPACING
Sc	485	Sambucus Canadensis	Elderberry	Ø5 - 12m Ht.	Potted, 1m SPACING
Vd	160	Viburnum Dentatum	Aronwood	Ø5 - 12m Ht.	Potted, 1m SPACING
Rc	100	Rubus Odoratus	Raspberry	Ø5 - 12m Ht.	Potted, 1m SPACING
<b>ZONES 2-3 EMERGENT PLANTING POND</b>					
F1	10	Alisma Plantago-Aquatica	Common Water Plantain		
	10	Andropogon Gerardi	Canada Bluemoss		
	10	Carex Crinita	Fringed Sedge		
F2	10	Carex Crinita	Fringed Sedge		
	10	Sagittaria Latifolia	Arrowhead		
	10	Scirpus Sp.	Bulrush		
F3	10	Alisma Plantago-Aquatica	Common Water Plantain		
	10	Carex Crinita	Fringed Sedge		
F4	10	Typha Latifolia	Cattail		
	10	Andropogon Gerardi	Canada Bluemoss		
	10	Sagittaria Latifolia	Arrowhead		
	10	Scirpus Sp.	Bulrush		
F5	10	Alisma Plantago-Aquatica	Common Water Plantain		
	10	Andropogon Gerardi	Canada Bluemoss		
	10	Carex Crinita	Fringed Sedge		
F6	10	Carex Crinita	Fringed Sedge		
	10	Sagittaria Latifolia	Arrowhead		
F7	10	Alisma Plantago-Aquatica	Common Water Plantain		
	10	Carex Crinita	Fringed Sedge		
	10	Typha Latifolia	Cattail		
F8	10	Andropogon Gerardi	Canada Bluemoss		
	10	Sagittaria Latifolia	Arrowhead		
	10	Scirpus Sp.	Bulrush		
F9	10	Carex Crinita	Fringed Sedge		
	10	Sagittaria Latifolia	Arrowhead		
F10	10	Alisma Plantago-Aquatica	Common Water Plantain		
	10	Andropogon Gerardi	Canada Bluemoss		
	10	Sagittaria Latifolia	Arrowhead		
	10	Scirpus Sp.	Bulrush		
F11	10	Alisma Plantago-Aquatica	Common Water Plantain		
	10	Andropogon Gerardi	Canada Bluemoss		
	10	Carex Crinita	Fringed Sedge		
F12	10	Carex Crinita	Fringed Sedge		
	10	Sagittaria Latifolia	Arrowhead		
	10	Scirpus Sp.	Bulrush		
F13	10	Alisma Plantago-Aquatica	Common Water Plantain		
	10	Andropogon Gerardi	Canada Bluemoss		
	10	Sagittaria Latifolia	Arrowhead		
	10	Scirpus Sp.	Bulrush		
F14	10	Alisma Plantago-Aquatica	Common Water Plantain		
	10	Carex Crinita	Fringed Sedge		
	10	Typha Latifolia	Cattail		

F15	10	Alisma Plantago-Aquatica	Common Water Plantain		
	10	Andropogon Gerardi	Canada Bluemoss		
	10	Carex Crinita	Fringed Sedge		
<b>TB0 TOTAL</b>					
<b>ZONES 1-2 SUBMERGENT</b>					
		ALL PLANTS		10cm Pot	Ø8 - 10m O.C.
F51	15	Ceratophyllum Demersum	Coottail		
	15	Elodea Canadensis	Waterweed		
F52	15	Myriophyllum Sibiricum	Northern Water Milfoil		
	15	Elodea Canadensis	Waterweed		
	15	Potamogeton Pustillus	Slender Pondweed		
	15	Vallisneria Americana	Tape Grass		
F53	15	Ceratophyllum Demersum	Coottail		
	15	Myriophyllum Sibiricum	Northern Water Milfoil		
	15	Potamogeton Pustillus	Slender Pondweed		
F54	15	Myriophyllum Sibiricum	Northern Water Milfoil		
	15	Potamogeton Pustillus	Slender Pondweed		
	15	Vallisneria Americana	Tape Grass		
F54	15	Ceratophyllum Demersum	Coottail		
	15	Elodea Canadensis	Waterweed		
	15	Myriophyllum Sibiricum	Northern Water Milfoil		
F55	15	Ceratophyllum Demersum	Coottail		
	15	Myriophyllum Sibiricum	Northern Water Milfoil		
	15	Potamogeton Pustillus	Slender Pondweed		

F56	15	Elodea Canadensis	Waterweed		
	15	Potamogeton Pustillus	Slender Pondweed		
	15	Vallisneria Americana	Tape Grass		
F57	15	Ceratophyllum Demersum	Coottail		
	15	Myriophyllum Sibiricum	Northern Water Milfoil		
	15	Potamogeton Pustillus	Slender Pondweed		
F58	15	Elodea Canadensis	Waterweed		
	15	Potamogeton Pustillus	Slender Pondweed		
	15	Vallisneria Americana	Tape Grass		
F59	15	Ceratophyllum Demersum	Coottail		
	15	Elodea Canadensis	Waterweed		
	15	Myriophyllum Sibiricum	Northern Water Milfoil		
<b>540 TOTAL</b>					

NOTES:  
 PLANTABLE AREA BLOCK 168, SWMP #3 6000m<sup>2</sup>  
 - SEED ALL AREAS WITHIN STORMWATER MANAGEMENT POND IN ACCORDANCE WITH DETAIL 5/SUL5.  
 - PLANT PODS WITHIN NUL ARE GENERAL IN SIZE AND LOCATION. LOCATIONS TO BE DETERMINED ON SITE WITH LANDSCAPE ARCHITECT.  
 - WHERE PLANT KEYS ARE GROUPED, SPECIES SHOULD BE MIXED RANDOMLY.

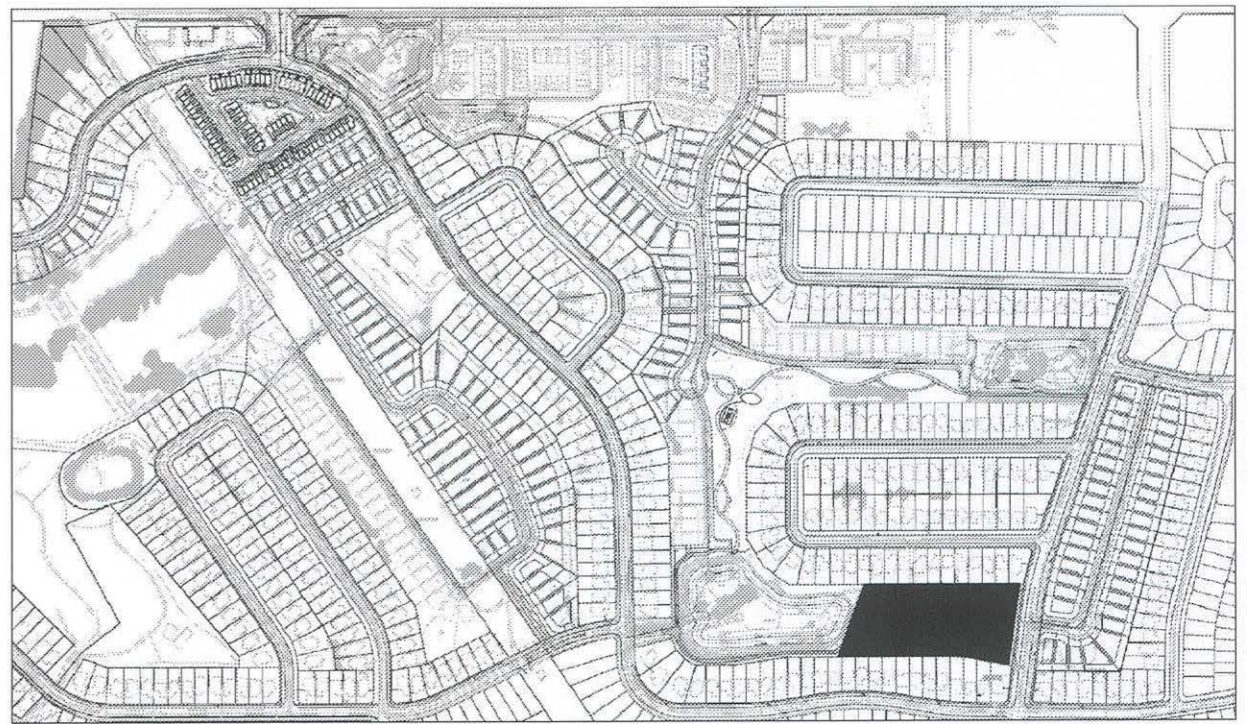

3 KEY PLAN  
 SULL3 SCALE: N.T.S.



1 LANDSCAPE PLAN  
 SULL3 SCALE: 1:400

2 BLOCK 168 EAST PLANT LIST  
 SULL3 SCALE: N.T.S.

Set No.

NOTES:  
 1. VERIFY ALL DIMENSIONS PRIOR TO CONSTRUCTION.  
 2. DO NOT SCALE DRAWINGS.  
 3. REPORT ALL DISCOVERIES OF ERRORS, OMISSIONS, OR DISCREPANCIES TO THE ARCHITECT OR DESIGN ENGINEER AS APPLICABLE.  
 4. USE ONLY LATEST REVISED DRAWINGS OR THOSE THAT ARE MARKED "ISSUED FOR CONSTRUCTION".  
 5. THE DRAWINGS ARE THE PROPERTY OF THE ARCHITECT AND/OR ENGINEER AND MUST BE RETURNED ON COMPLETION OF THE PROJECT. ANY UNAUTHORIZED USE IS PROHIBITED.  
 6. AREA CALCULATIONS ARE APPROXIMATE.

ISSUE & REVISION DESIGNATION  
 LETTER (A) = ISSUE, No. (1) = REVISION

No.	Date	Issued For / Revisions
A	OCT 8 2014	SUBMISSION TO NEWMARKET
B	DEC 10 2014	RESUBMISSION TO NEWMARKET
C	MAR 30 15	RESUBMISSION 2 TO NEWMARKET

- LEGEND
- KEY TO PLANT LIST
  - QUANTITY
  - CONCRETE PAVING
  - ASPHALT PAVING
  - SOD
  - DECIDUOUS TREE
  - SHRUBS
  - CONIFEROUS TREE
  - TREE TO BE PROTECTED
  - TRANSPLANT TREE. SPECIES & LOCATIONS TO BE CONFIRMED BY LANDSCAPE ARCHITECT ON SITE
  - NORMAL WATER LEVEL (NUL)
  - HIGH WATER LEVEL (HUL)
  - VEGETATED RIFRAP. (SEE ENG. DUGS)
  - RIFRAP. (SEE ENG. DUGS)

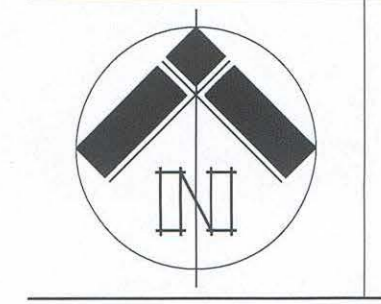

**York Urbanist**  
 25 Main Street, Kleinburg, ON, L0J 1C0  
 yorkurbanist@gmail.com www.yorkurbanist.com  
 416-770-8862

Project: Estates of Glenway

Drawing: BLOCK 168 EAST LANDSCAPE PLAN

Drawn By: AS	Job Captain: MI	Project No.: 1411
Scale: AS SHOWN		
Plot Date: MAR 20, 2015		Sheet No.:
Current Issue: C	Current Revision:	SWL3